

# Fowler

## Sylvac Ultra-Light Mark II Calipers



Fowler/Sylvac's line of lightweight heavy-duty electronic digital calipers include ranges to 60" (1500mm) and resolution of .0005" (.01mm). This has been achieved by designing a well-balanced instrument utilizing state-of-the-art material technology. Functional parts are made of the latest wear-resistant materials. For example, the main beam is a hardened stainless steel box construction filled with epoxy resin for stability, strength and lightness.

Constant measuring pressure control ensures constant measuring force and parallel pressure on jaws. It's important with large calipers, since measuring pressure plays an important part when checking large diameters on bores.

These Calipers offer many advantages over conventional calipers: Lightness improves measuring results. Both jaws are moveable for better balance. Measuring pressure control (improved repeatability). Contact faces on bottom jaws are titanium-coated on hardened steel. Top jaws are solid carbide

### Special Features:

- New hold feature freezes display for later viewing. Ideal for hard to reach places.
- Incremental floating zero. Deviations are read out directly with no math.
- Two moveable jaws can be independently locked in any position. Jaws can be adjusted over the length of the beam.
- Completely re-engineered measuring sensor is a marked improvement of the proven Sylvac capacitive measuring system.
- Large, high-contrast LCD display indicates in/mm, hold and zero functions.
- Low drain, high efficiency lithium wafer battery—4500 hrs. of continuous on-time.
- Direct inch/metric conversion.
- Direct RS232C output connects tool to any computer or printer without an interface.
- Special application accessories available.
- Includes fitted wooden case.

### Specifications:

- External Jaws: Length = 6" (150mm); thickness = .275" (7mm); material: titanium coated stainless steel.
- Internal Jaws: Length = .71" (18mm) diameter of nibs = .197" (5mm); material = tungsten carbide.
- Measuring Speed = 60"/1.5m per second.



| Order No.  | Range  | Accuracy      | Repeatability    | Weight         |
|------------|--|---------------|------------------|----------------|
| 54-110-012 | 0-12"/300mm  | .0012"(.03mm) | .0008"(.02mm)±2s | 2.5 lb(1.15kg) |
| 54-110-024 | 0-24"/600mm  | .0016"(.04mm) | .0008"(.02mm)±2s | 3.0 lb(1.35kg) |
| 54-110-040 | 0-40"/1000mm   | .0025"(.06mm) | .0008"(.02mm)±2s | 3.5 lb(1.6kg)  |
| 54-110-060 | 0-60"/1500mm   | .006"(.15mm)  | .0008"(.02mm)±2s | 4.1 lb(1.9kg)  |
| 54-110-112 | Replacement wood case for #54-110-012  |               |                  |                |
| 54-110-124 | Replacement wood case for #54-110-024  |               |                  |                |
| 54-110-140 | Replacement wood case for #54-110-040  |               |                  |                |
| 54-110-160 | Replacement wood case for #54-110-060  |               |                  |                |
| 54-115-333 | Simplex Connection Kit. Includes 80"(2m) 9 pin cable, GageWedge Software support disk. |               |                  |                |

# Fowler

## Sylvac Ultra-Light Mark II Calipers

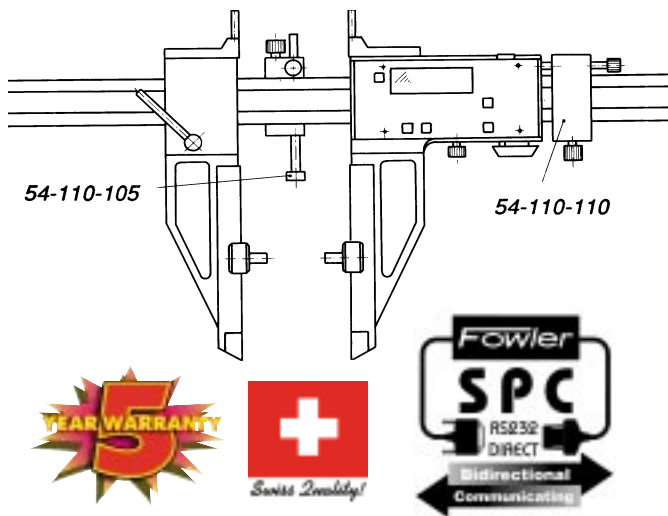
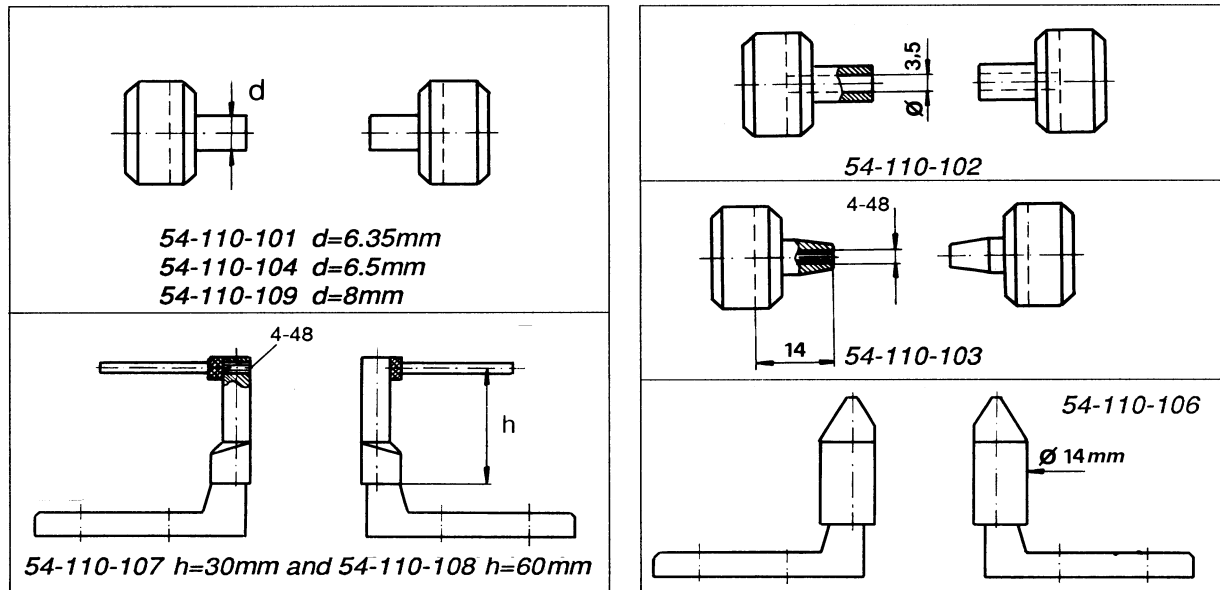

▲ 54-110-000 stand shown with caliper & printer.



| Order No.  | Description  |
|------------|--|
| 54-110-000 | Stand for 54-110 series  |
| 54-110-100 | Accessory Set for Heavy duty Calipers                                |
| 54-110-101 | Thread wire holder, diameter 6.35mm (optional) pair                  |
| 54-110-102 | Thread insert holder, diameter 3.5mm (included with 54-110-100) pair |
| 54-110-103 | Contact Point holder, 4-48 thread (included with 54-110-100) pair    |
| 54-110-104 | Thread wire holder, diameter 6.5mm (included with 54-110-100) pair   |
| 54-110-105 | Adjustable stop (included with 54-110-100)                           |
| 54-110-106 | Centerline cones 14mm (included with 54-110-100) pair                |
| 54-110-107 | Groove attachment, 30mm (included with 54-110-100) pair              |
| 54-110-108 | Groove attachment, 60mm (included with 54-110-100) pair              |
| 54-110-109 | Thread wire holder, diameter 8mm (optional) pair                     |
| 54-110-110 | Fine adjustment device (included with 54-110-100)                    |