

Fowler

Deluxe Digital Caliper Gages



54-554-025

54-554-010

- Perfect for measuring bores, thickness, o-ring and snap-ring grooves
- Fast and accurate measuring results
- Absolute and relative measurements
- Operates on a 3V lithium battery
- Inch/metric conversion
- Large LCD display
- Peak measuring modes
- Suitable for workshop use
- Data transfer via RS 232 and MTI Digimatic serial cables
- Price includes test certificate, operating instructions, battery, hexagon socket screw key, and a fitted carton



External Calipers

#54-554-012

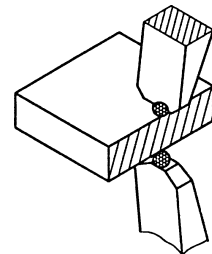
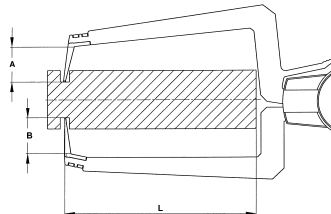
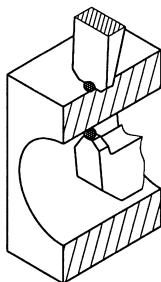
#54-554-025
54-554-205

External Specs	Key	54-554-012	54-554-025	54-554-205
Measuring range		.008—.5" (.2—12.5mm)	.01—1.0" (.3—25mm)	.02—2.0" (.5—50mm)
Travel		.492"(12.3mm)	.990"(24.7mm)	1.980"(49.5mm)
Resolution		.0002"(.005mm)	.0005"(.01mm)	.001"(.02mm)
Accuracy		±.0006"(.015mm)	±.0008"(.02mm)	±.0016"(.04mm)
Repeatability		.0008"(.02mm)	.0008"(.02mm)	.0016"(.04mm)
Arm length	L	.984"(25mm)	3.15"(80mm)	6.70"(170mm)
Type of measuring contact		Ø .059"(1.5mm)	Ø .059"(1.5mm)	Ø .079"(2mm)
Measuring contact length/movable	A	.866"(22mm)	.866"(22mm)	1.26"(32mm)
Measuring contact length/fixed	B	.039"(1mm)	.866"(22mm)	1.26"(32mm)
Measuring force		0.9N—1.5N	0.9N—1.5N	1.2N—2.0N



Internal Calipers

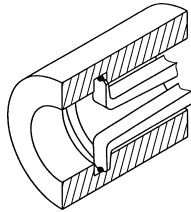

#54-554-005
54-554-010
54-554-030
54-554-050
54-554-070
54-554-207

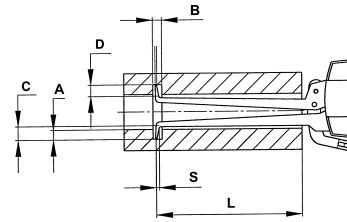

Internal Specs		Key	54-554-005	54-554-010	54-554-030
Measuring range	in		.2—.7"	.4—1.4"	1.2—2.2"
	mm		(5—17.5mm)	(10—35mm)	(30—55mm)
Travel			.5"(12.5mm)	1"(25mm)	1"(25mm)
Resolution			.0002"(.005mm)	.0005"(.01mm)	.0005"(.01mm)
Accuracy			±.0008"(.02mm)	±.0012"(.03mm)	±.0012"(.03mm)
Repeatability			.0005"(.015mm)	.0012"(.03mm)	.0012"(.03mm)
Arm length		L	.787"(20mm)	3.15"(80mm)	3.15"(80mm)
Groove depth		A	.06"(1.5mm)	.177"(4.5mm)	.236"(6mm)
Groove width		B	.051"(1.3mm)	.067"(1.7mm)	.098"(2.5mm)
Type of measuring contact			Ø .03"(0.8mm) ball	Ø .04"(1mm) ball	Ø .04"(1mm) ball
Measuring contact length/movable		D	.100"(2.5mm)	.197"(5mm)	.276"(7mm)
Measuring contact length/fixed		C	.100"(2.5mm)	.197"(5mm)	.276"(7mm)
Measuring contact thickness		S	.047"(1.2mm)	.047"(1.2mm)	.075"(1.9mm)
Measuring force			0.9N—1.5N	0.9N—1.5N	0.9N—1.5N

Internal Specs		Key	54-554-050	54-554-070	54-554-207
Measuring range	in		2—3"	2.8—3.8"	2.8—4.8"
	mm		(50—75mm)	(70—95mm)	(70—120mm)
Travel			1"(25mm)	1"(25mm)	2"(50mm)
Resolution			.0005"(.01mm)	.0005"(.01mm)	.0008"(.02mm)
Accuracy			±.0012"(.03mm)	±.0012"(.03mm)	±.0016"(.04mm)
Repeatability			.0012"(.03mm)	.0012"(.03mm)	.0016"(.04mm)
Arm length		L	3.15"(80mm)	3.15"(80mm)	6.89"(175mm)
Groove depth		A	.315"(8mm)	.315"(8mm)	.315"(8mm)
Groove width		B	.118"(3mm)	.177"(4.5mm)	.130"(3.3mm)
Type of measuring contact			Ø .04"(1mm) ball	Ø .04"(1mm) ball	Ø .08"(2mm) ball
Measuring contact length/movable		D	.394"(10mm)	.394"(10mm)	.413"(10.5mm)
Measuring contact length/fixed		C	.787"(20mm)	.787"(20mm)	1.595"(40.5mm)
Measuring contact thickness		S	.098/.157"(2.5/4mm)	.098/.157"(2.5/4mm)	.098/.197"(2.5/5mm)
Measuring force			0.9N—1.5N	0.9N—1.5N	1.2N—2.0N



Order No.	Range	Description
54-554-005	.2—.7"(5—17.5mm)	Internal Electronic Caliper
54-554-010	.4—1.4"(10—35mm)	Internal Electronic Caliper
54-554-030	1.2—2.2"(30—55mm)	Internal Electronic Caliper
54-554-050	2.0—3.0"(50—75mm)	Internal Electronic Caliper
54-554-070	2.8—3.8"(70—95mm)	Internal Electronic Caliper
54-554-207	2.8—4.8"(70—120mm)	Internal Electronic Caliper
54-554-012	.008—.5"(.2—12.5mm)	External Electronic Caliper
54-554-025	.01—1.0"(.3—25mm)	External Electronic Caliper
54-554-205	.02—2.0"(.5—50mm)	External Electronic Caliper
54-554-100		Replacement 3V Lithium DL123AB Battery
54-554-101		RS232 Output Cable
54-554-102		MTI Output Cable