

Fowler

Mini-Vertical Series II—12" & 24"

Fowler's Mini-Vertical Series II, a self-contained height measuring and scribing instrument, now with direct RS232 output and resolution of .00005"/.001mm. The new generation Mini-Vertical uses all the same accessories as its predecessor.

Features

- Zero setting at any position.
- .00005"/.001mm or .0005"/.01mm resolution.
- Input of preset values and recall.
- mm/inch selection
- Setting and display of tolerance limits.
- Min/max/tir modes.
- Hold display function.
- Two reference datums (Ref. I/Ref. II)
- Compact appearance and versatility of application.
- Accurate and positive measurements.
- Ease of handling.
- Direct Opto RS232C data output allows connection to printer or computer.
- Bi-directional data output



**Now with
.00005"/.001mm
Resolution**

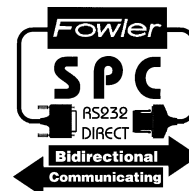



Specifications

Model	#54-180-212 & 215	#54-180-224 & 226
Measuring range	12.6" (320mm)	24.4" (620mm)
Accuracy over full range (maximum error)	.0008" (.02mm)	.0012" (.03mm)
Measuring pressure (under preload)	Approx. 3N (10.5 ounces)	
Max. displacement velocity of measuring carriage	40"/sec. (1m/sec.)	
Measuring system	Built-in Sylvac system (patented)	
Display	LCD display. Height .335" (8.5mm)	
Power supply	3 V lithium battery (1) #CR 2032/190 mAh Approx. 2000 operational hours	
Data output	Opto RS232	
Cast iron base Dimensions	length 7.08"(180mm) x width 4.02"(102mm)	length 7.87"(200mm) x width 5.52"(140mm)
Granite base Dimensions	length 7.87"(200mm) x width 11.8"(300mm)	length 7.87"(200mm) x width 11.8"(300mm)
Surface Accuracy (granite base)	grade 1 (5µm/.0002")	



Standard Equipment

Each unit includes:

- Main probe holder 5.9"(150mm)
- Connector with 8mm location bore
- One ball probe 8mm diameter
- Protection cover
- Instruction manual
- Test and guarantee certificate. **New**



Order No.	Description
54-180-212	12.6"(320mm) Mini-Vertical with cast iron base
54-180-215	12.6"(320mm) Mini-Vertical with granite base
54-180-224	24.4"(620mm) Mini-Vertical with cast iron base
54-180-226	24.4"(620mm) Mini-Vertical with granite base
54-115-333*	Computer Connect Kit. Includes 80"(2m) connecting cable with 9 pin IBM compatible, 9/25 pin adaptor, support disk & instruction book.
54-115-334*	Half duplex adaptor cable. Adds bidirectional RS232 capability.



12" & 24" Mini-Vertical II Accessories

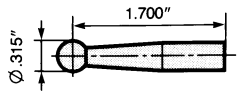

▲ Standard Ball Probe.
#54-180-060

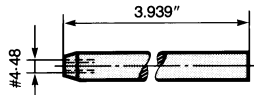

▲ #4-48 probe shaft
for Indicator Points.
#54-180-031

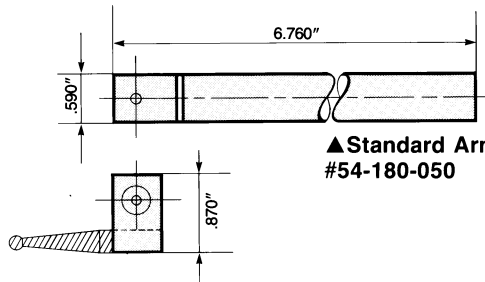

▲ Standard Arm
#54-180-050

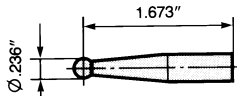

▲ .236" Diameter
Ball Probe.
#54-180-236

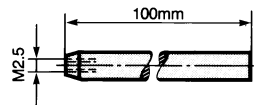

▲ Metric probe shaft
for Indicator Points.
#54-180-030

▲ Standard Intermediate Connector.
(Used with Standard Arm).
#54-180-055

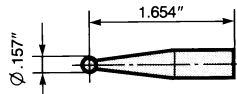

▲ .157" Diameter
Ball Probe.
#54-180-157

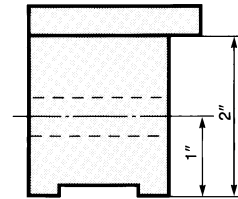

▲ "Inch" Setting Gauge
for Centering Cones
and Probe constant.
#54-180-046

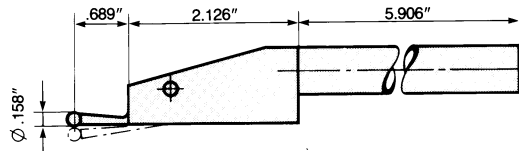

▲ Bi-directional Probe.
#54-180-040

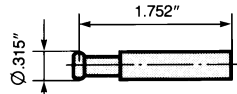

▲ Disc shape Probe.
#54-180-315

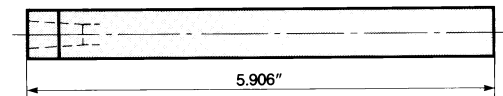

▲ Centering Cone Holder.
#54-180-035

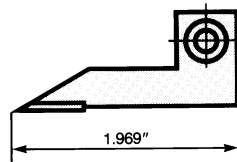

▲ Scriber attachment.
#54-180-025

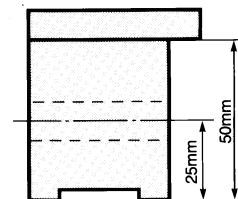

▲ Metric Setting Gauge
for Centering Cones
and Probe constant.
#54-180-045

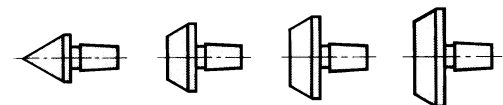

0-.591" #54-180-036 .552"-.787" #54-180-037 .709"-.945" #54-180-038 .906"-1.181" #54-180-039

▲ Centering Cones.
Available individually or in sets.

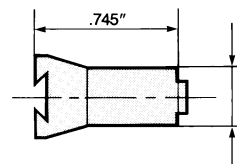

▲ Dovetail Clamp
for Indicators.
#52-565-093



Fowler

12" & 24" Mini-Vertical II Accessories

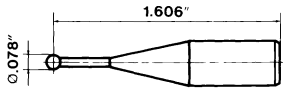

▲ .080" Dia. Ball
Probe #54-180-152.

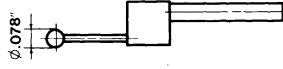

▲ .080" Dia. contact point for Bi-
directional Probe #54-180-042.

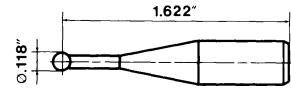

▲ .120" Dia. Ball
Probe #54-180-153.

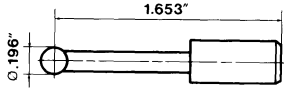

▲ .200" Dia. Ball Probe #54-180-155.

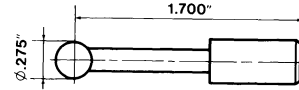

▲ .280" Dia. Ball Probe #54-180-156.



Order No.	Description
54-180-014	Wood case for 54-180-212.
54-180-018	Centering cone 1.020"-1.380" (26-35mm) range.
54-180-019	Centering cone 1.160"-1.570" (29.5-40mm) range.
54-180-020	Centering cone 1.370"-1.770" (35-45mm) range.
54-180-021	Centering cone 1.530"-1.970" (39-50mm) range.
54-180-022	Centering cone 1.810"-2.160" (46-55mm) range.
54-180-023	Centering cone 1.960"-2.360" (50-60mm) range.
54-180-025	Scriber attachment, carbide-tipped.
54-180-030	Probe shaft. M2.5 metric contact point threads. (Without contact point).
54-180-031	Probe shaft. #4-48 contact point threads. (Without contact point).
54-180-034	Set: 4 cones (54-180-036,037,038 & 039) 0-1.180" (0-30mm) range.
54-180-035	Centering cone holder. (For all sizes of centering cones).
54-180-036	Centering cone 0-.590" (0-15mm) range.
54-180-037	Centering cone .550"-.780" (14-20mm) range.
54-180-038	Centering cone .710"-.940" (18-24mm) range.
54-180-039	Centering cone .900"-1.180" (23-30mm) range.
54-180-040	Bi-directional probe, .156" diameter.
54-180-041	Bi-directional probe, .080" diameter.
54-180-042	Bi-directional replacement point .080" diameter.
54-180-043	Bi-directional replacement point .156" diameter.
54-180-045	Setting gage. Metric series.
54-180-046	Setting gage. Inch series.
54-180-050	Standard arm. (Included with unit).
54-180-055	Standard intermediate connector. (Included with unit).
54-180-060	Ball shape probe .315" diameter. (Standard, included with unit).
54-180-152	Ball probe .080" diameter.
54-180-153	Ball probe .120" diameter.
54-180-155	Ball probe .200" diameter.
54-180-156	Ball probe .280" diameter.
54-180-157	Ball shape probe .157" diameter.
54-180-236	Ball shape probe .236" diameter.
54-180-315	Disc shape probe .315" diameter.
52-565-093*	Dovetail clamp for test indicators.
54-100-350**	Replacement battery. Included with unit.